

# MB-ST.375 Hollow Shaft Encoder Shaft Stubs

## DESCRIPTION

The MB-ST.375 can be installed on the end of a conveyor roller to provide a mounting shaft for a hollow shaft encoder, such as the HS20 or HS25 encoders. The HS20 or HS25 should be ordered with a 3/8" shaft bore so it fits the MB-ST.375

## INSTALLATION

1. Drill and tap either a 5/16-18, 10-24, or 3/8-16 hole, at least 1/2" deep, into the end of the conveyor roller. The hole must be centered and in-line with the conveyor roller axis so there is minimum wobble when the roller is rotating.
2. Insert the MB-ST.375 shaft stub. Tighten with a 3/16" hex key or a screw driver.
3. Install the HS20 or HS25 hollow shaft encoder onto the shaft stub and tighten the set screws.

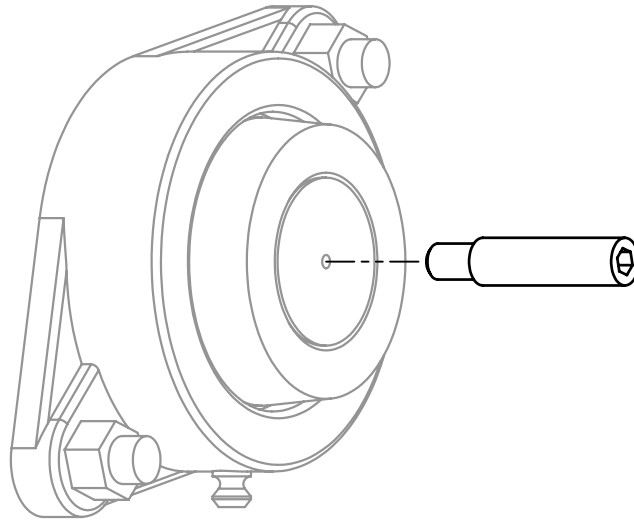

Figure 1: MB-ST.375 and conveyor roller bearing

## DIMENSIONS

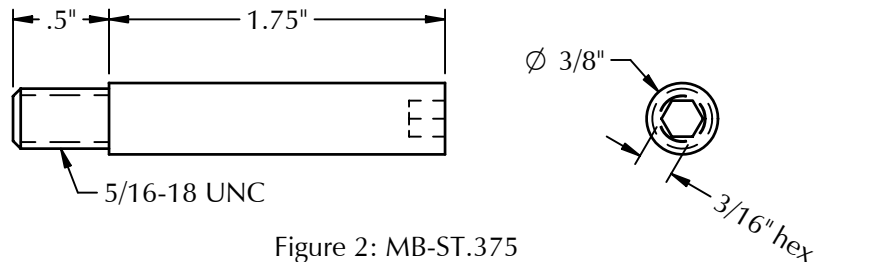

Figure 2: MB-ST.375

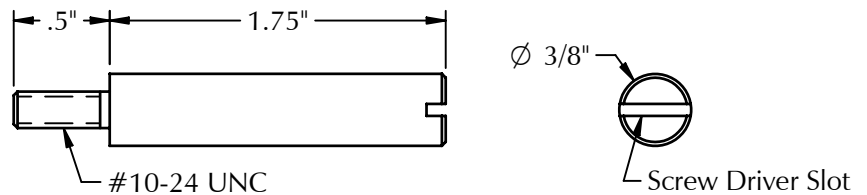

Figure 3: MB-ST.375A

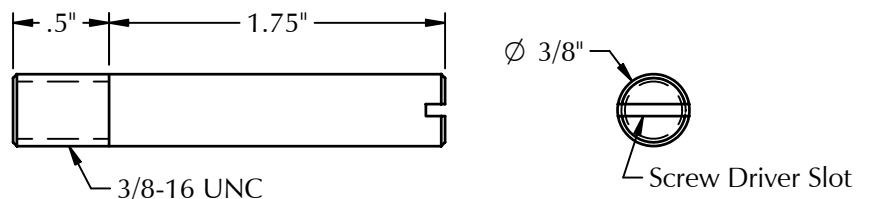

Figure 4: MB-ST.375B



PO Box 25135 813-886-4000  
Tampa FL 33622-5135, USA 800-237-0946  
[tco.com](http://tco.com) • [photocraftencoders.com](http://photocraftencoders.com)