

DIMENSIONS

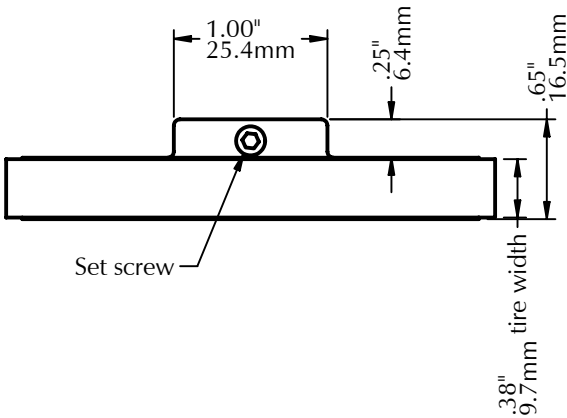
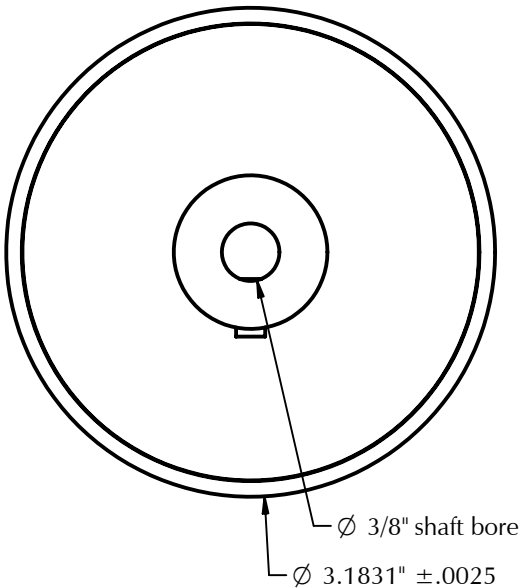

DESCRIPTION

The **MW-10** measuring wheel provides an accurate way to precisely measure linear movement of a conveyor or web when used with the R21, R22 or RH wheeled encoders. The wheels are aluminum with a urethane tire with a precisely ground tread, and having a high coefficient of friction that resists slipping. They attach to an encoder shaft using a 10-24 set screw.

SPECIFICATIONS

MW-10 dimensions: 10.00" ± .008" circumference
3.1831" ± .0025" diameter
Shore Hardness of tire: 83A
Operating Temperature Range: -25° to 65°C, -20° to 150°F
Urethane is FDA compliant, food grade.

INSTALLATION and MAINTENANCE

Measuring wheels should be installed such that they are perpendicular to and their rotation is directly in line with the moving web or conveyor, or there could be premature wheel tread wear. For the double wheel R22 and RH encoders, use of the Y-1, Y-3, MB-T, MB-UB1, MB-UB2, MB-UB3, or MB-UB4 mounting adapters allow the encoder to self-align with the moving web. The underbelt and torsion spring adapters apply a force that is directly along the centerline of the R22 or RH encoder, minimizing wheel wear. On curved sections of conveyors, we recommend the use of the IW modification with the RH encoder, or use a single wheeled encoder. Special care must be used when installing the single wheel R21 encoder to ensure it is properly aligned.

Maintenance consists of periodically cleaning the wheel tread. In dirty environments this is especially important since dirt accumulation on the wheel will increase its diameter.

MODEL NUMBERS

MW			
Measuring Wheel	Circumference: 10=10" (3.1831" dia.)	Type: leave blank for standard width (there are no other options at this time)	Shaft Size: B=3/8" (there are no other options at this time)

Examples: MW-10-B (10" circumference, 3/8" shaft)



PO Box 25135 813-886-4000
Tampa FL 33622-5135, USA 800-237-0946
tco.com • photocraftencoders.com