

4-40 tap .28" deep on  
1.00" Dia. bolt circle (4)

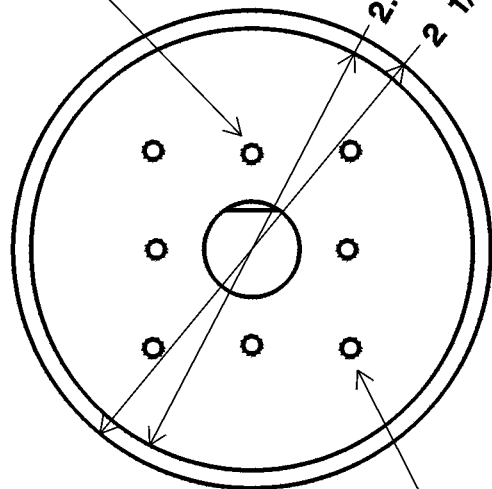

4-40 tap .28" deep on  
1.46" Dia. bolt circle (4)

2.312" Dia.  
2 1/2" Dia.

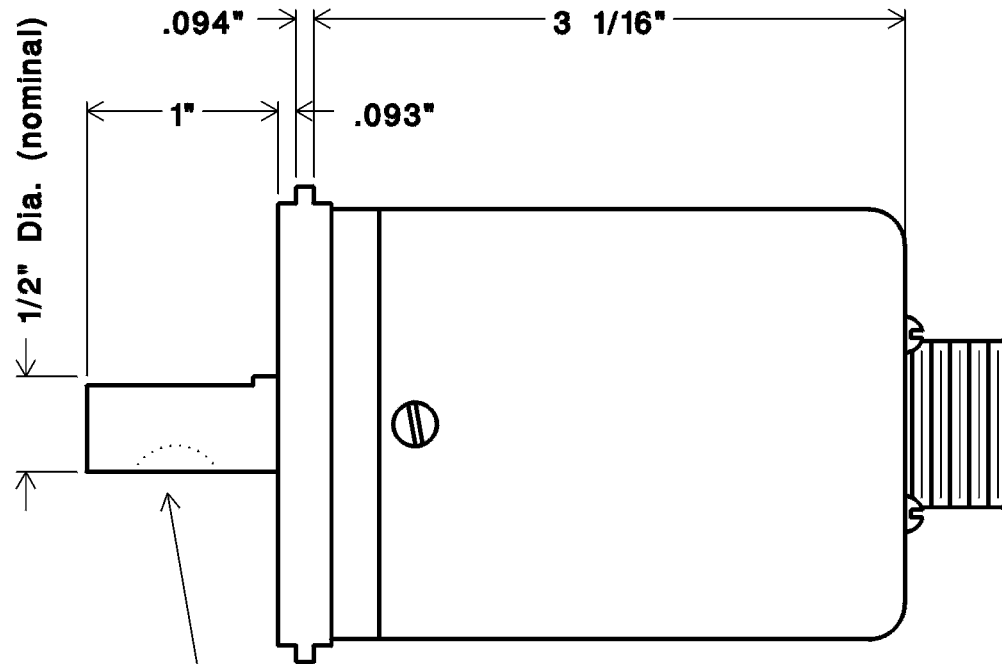

Woodruff key slot

**Connections**

- A Common
- B Supply voltage
- C Output Z
- D Output A
- E Output B
- F Case ground

See RJ datasheet for more information

Rev	Description	Date	Tolerances	M77: RJ encoder with modified shaft and adapter (ECCL ON25-1024...)		
			.XXXX ± .0005 .XXX ± .005 .XX ± .01 .X ± .015 Fractions ± 1/32 Angles ± 15 min. Runout ± .003 <small>Unless otherwise specified</small>	BY:	MAT'L: 33A058 adapter, 34A015 shaft	
				DATE: 6/2/93	FINISH:	SCALE: 1 : 1
				<b>PHOTOCRAFT, Inc.</b> Elburn, Illinois 8A077		