

MB-ST-M12 Hollow Shaft Encoder Shaft Stubs

DESCRIPTION

The MB-ST-M12 can be installed on the end of a conveyor roller to provide a mounting shaft for a hollow shaft encoder, such as the HS20 or HS30 encoders. The HS20 or HS30 should be ordered with a 12mm shaft bore so it fits the MB-ST-M12.

INSTALLATION

1. Drill and tap a M10-1.5mm hole, at least 16mm deep, into the end of the conveyor roller. The hole must be centered and in-line with the conveyor roller axis so there is minimum wobble when the roller is rotating.

2. Insert the MB-ST-M12 shaft stub. Tighten with a 6mm hex key.

3. Install the HS20 or HS30 hollow shaft encoder onto the shaft stub and tighten the set screws.

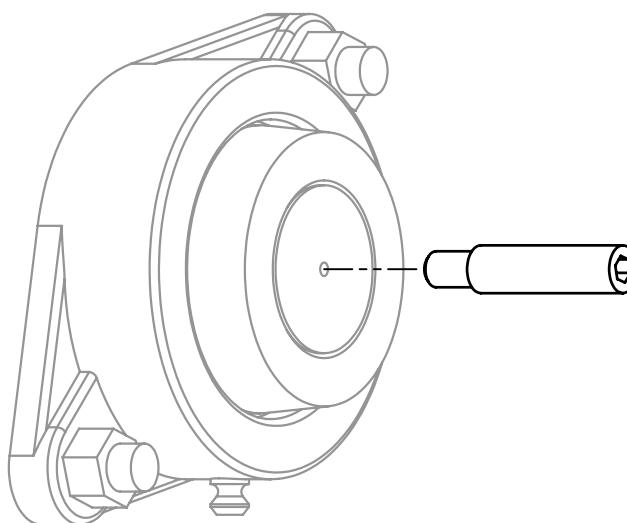

Figure 1: MB-ST-M12 and conveyor roller bearing

DIMENSIONS

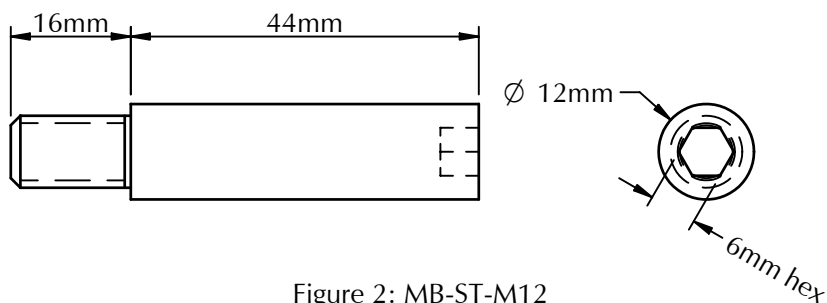

Figure 2: MB-ST-M12

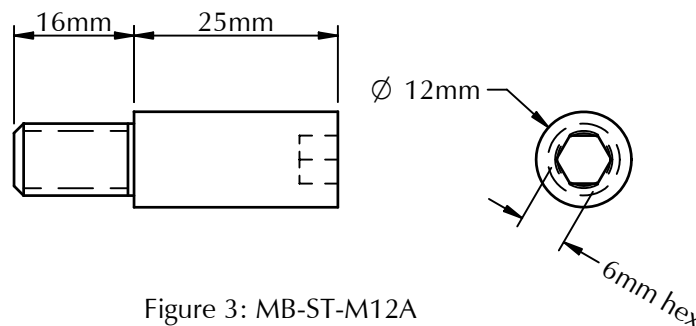

Figure 3: MB-ST-M12A