

# MB-UB6

# Wheeled Encoder Mounting Bracket

## DESCRIPTION

The MB-UB6 "L" bracket bolts to a cross beam above or below a conveyor belt, and provides an attachment point for a model R21, R22, or RH wheeled encoder. The bolts on the MB-UB6 allow the encoder to be adjusted so the measuring wheels contact the conveyor belt.

Note: Because the encoder is rigidly fixed and cannot self-align with the conveyor belt, this bracket is not intended for continuous duty applications where rapid wear of the measuring wheel tread will occur if the wheels are not perfectly aligned with the belt movement.

## INSTALLATION

1. Attach the MB-UB6 "L" bracket to a cross beam that is several inches above or below the conveyor belt, ensuring that the correct bracket edge is nearest to the conveyor belt (see figure to the right). To minimize tread wear on the measuring wheel, the slotted flange of the "L" bracket must be exactly in-line with the conveyor belt movement, and its face must be perpendicular to the belt.

2. Connect the R21, R22 or RH encoder handle to the "L" bracket by inserting one of the three encoder mounting holes, either the middle hole or the hole nearest the encoder body, through the captive bolt on the "L" bracket. Loosely add washers and hex nut.

3. Insert the 5/16-18 x 1" hex bolt and washer through the curved "L" bracket slot and the encoder handle mounting hole. Loosely add washers and hex nut.

4. Adjust the encoder so the measuring wheel firmly contacts the encoder belt. Then tighten the hex nuts.

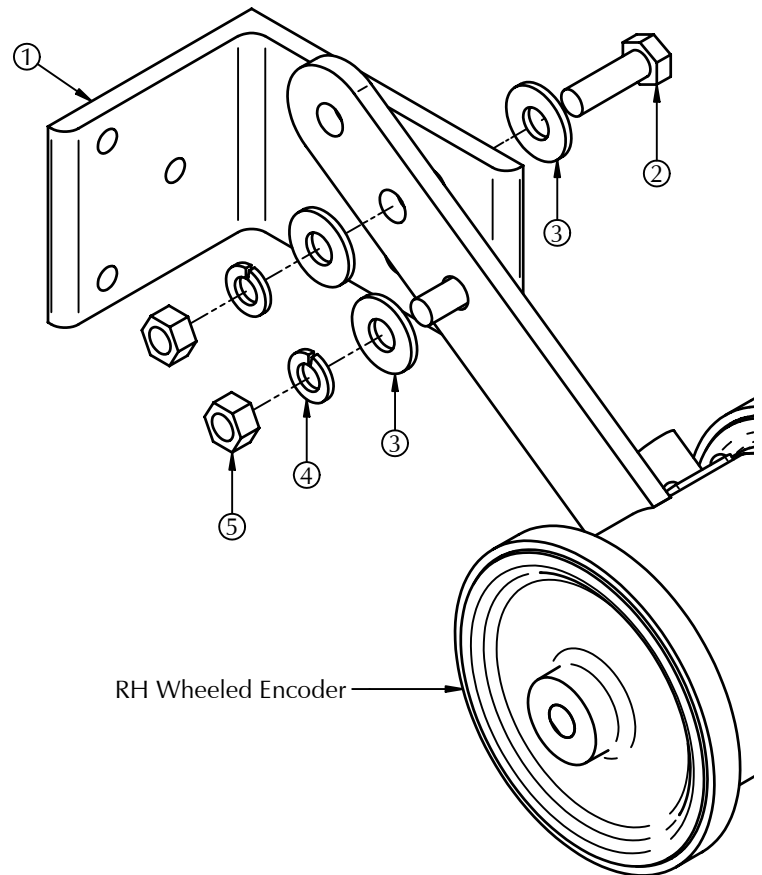

#	Description	Part No.	Qty
1	MB-UB6 "L" Bracket	500-MCH115	1
2	5/16-18 x 1" hex bolt	550-SCR306	1
3	5/16 flat washer	550-WSH008	3
4	5/16 split-lock washer	550-WSH009	2
5	5/16-18 hex nut	550-NUT009	2

### MB-UB6 "L" Bracket

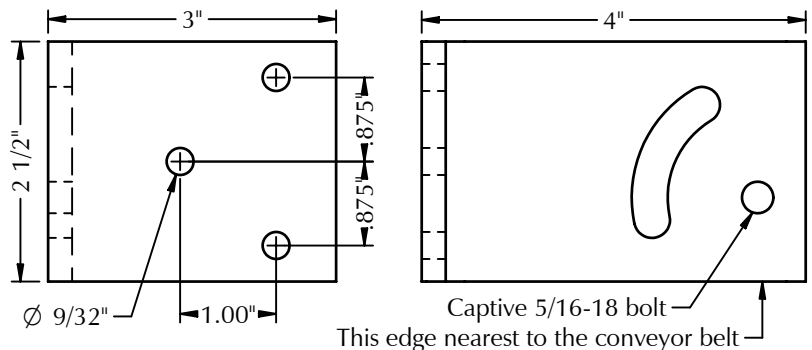

**MATERIAL HANDLING AND  
INDUSTRIAL EXPERIENCE  
SINCE 1974**

**HOTOCRAFT INC**

602 E. North Street      **630-365-7148**  
Elburn, IL 60119, USA      Fax: 630-365-7149  
[www.photocraftencoders.com](http://www.photocraftencoders.com)